

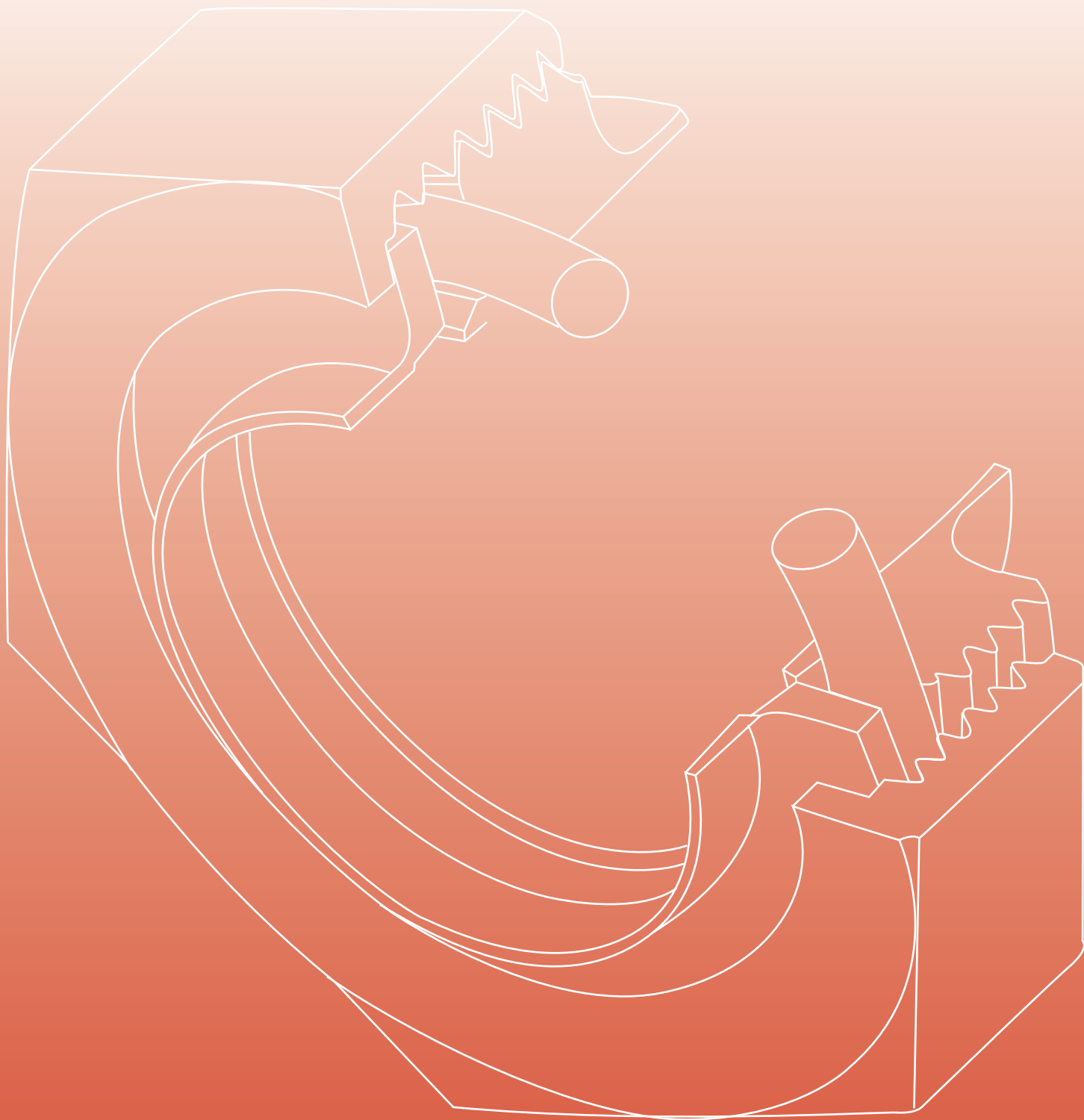

VICENTINOX

LAVORAZIONI INOX - RACCORDERIE - VALVOLE



RACCORDERIA IN ACCIAIO INOX
PER L'INDUSTRIA ALIMENTARE
FARMACEUTICA E CHIMICA

STAINLESS STEEL FITTINGS
FOR FOOD - PHARMACEUTICAL
AND CHEMICAL INDUSTRIES

RACCORDERIE EN ACIER INOXYDABLE
POUR L'INDUSTRIE ALIMENTAIRE
PHARMACEUTIQUE ET CHIMIQUE

RUBINETTI

ROBINETS - PLUG COCKS

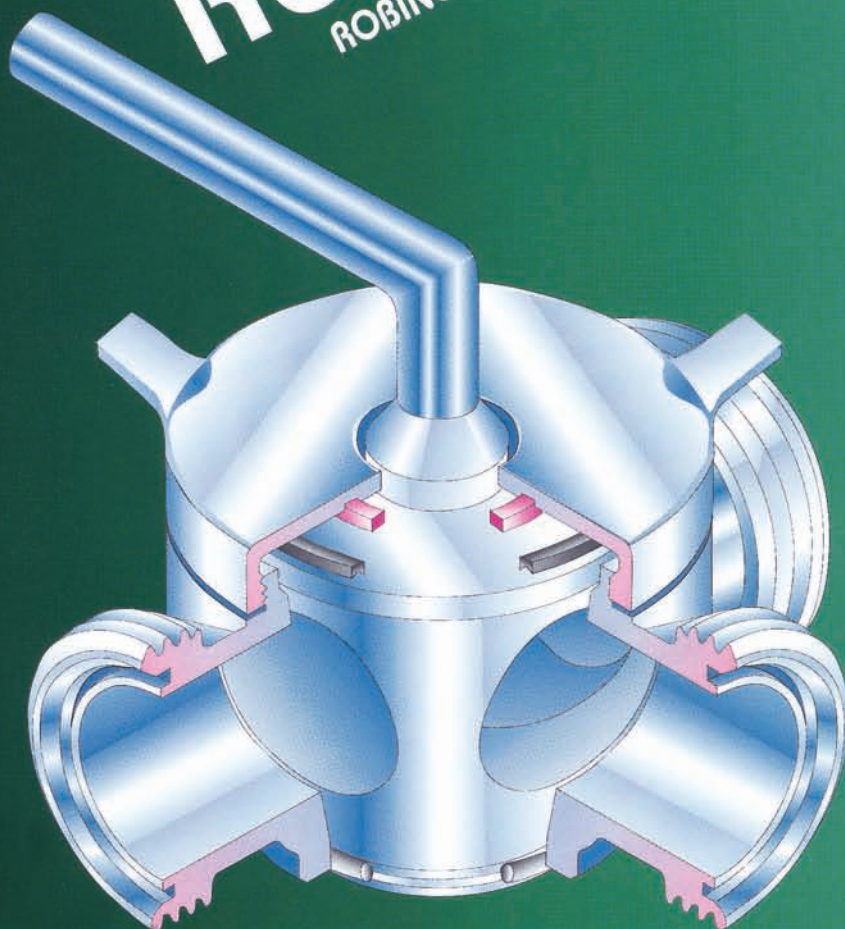

VICENTINOX

LAVORAZIONI INOX - RACCORDERIE - VALVOLE

RUBINETTI ROBINETS PLUG COCKS

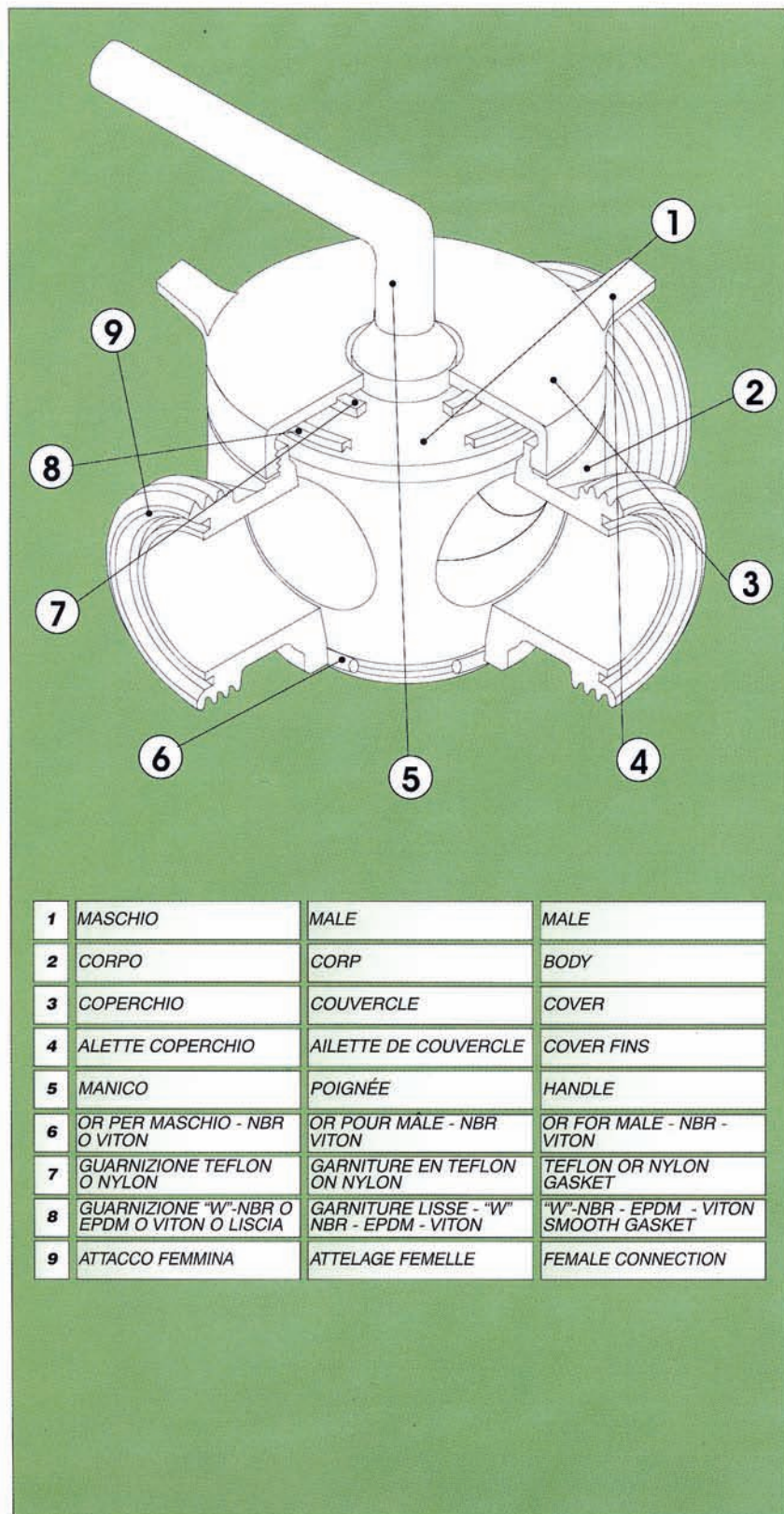

1	MASCHIO	MALE	MALE
2	CORPO	CORP	BODY
3	COPERCHIO	COUVERCLE	COVER
4	ALETTE COPERCHIO	AILETTE DE COUVERCLE	COVER FINS
5	MANICO	POIGNÉE	HANDLE
6	OR PER MASCHIO - NBR O VITON	OR POUR MÂLE - NBR VITON	OR FOR MALE - NBR - VITON
7	GUARNIZIONE TEFLON O NYLON	GARNITURE EN TEFLON ON NYLON	TEFLON OR NYLON GASKET
8	GUARNIZIONE "W"-NBR O EPDM O VITON O LISCIA	GARNITURE LISSE - "W" NBR - EPDM - VITON	"W"-NBR - EPDM - VITON SMOOTH GASKET
9	ATTACCO FEMMINA	ATTELAGE FEMELLE	FEMALE CONNECTION

RUBINETTI

Vengono ricavati da un unico pezzo completi di attacchi filettati o a saldare del tipo "DIN", a richiesta SMS - IDF - BS o liscio.

Sono costruiti normalmente in AISI 304 e NY 316 L. I maschi vengono sottoposti a cromatura.

Per consentire una adeguata diminuzione della pressione specifica, il maschio presenta una forte conicità opportunamente studiata.

Durante la fase di rotazione, la tenuta è garantita dalla guarnizione in gomma applicata sulla parte inferiore del maschio.

Pressione max di esercizio: 4 - 5 bar.

In base al tipo di gomma della guarnizione dipende la temperatura di esercizio, che può variare da -20 °C a +200 °C.

ROBINETS

Obtenus d'une pièce unique, complets d'éléments de fixation soudables ou filetés DIN (SMS - IDF - BS - lisse sur demande), en acier inox AISI 304 et NY 316L; les mâles des robinets sont recouverts avec une couche de chrome.

Afin de diminuer la pression spécifique les mâles sont réalisés en étudiant des conicités élevées.

La tenue pendant la rotation est garantie par la garniture en gomme fixée à la partie inférieure du mâle. Pression maxi de service 4-5 bar.

La température dépend du type de garniture en gomme et peut varier de -20°C a +200°C.

PLUG COCKS

Constructed from a single piece complete with weldable or threaded DIN connections (SMS - IDF - BS - smooth on demand), in AISI 304 and NY 316L stainless steel; male plugs are chrome coated.

In order to reduce the specific pressure, the male plug is specially designed with a high taper. Tightness during rotation is guaranteed by the rubber gasket fitted on the lower part of male.

Maximum working pressure: 4-5 bar.

Temperature is depending on the gasket rubber type and varies from -20°C to +200°C.

CARATTERISTICHE ELASTOMERI GUIDA GENERALE
CARACTERISTIQUES ELASTOMÈRE GUIDE GÉNÉRALE
ELASTOMER PROPERTIES GENERAL GUIDE

	Temperature	Acidi organici	Alcali diluiti	Olii vegetali Grassi animali	Idrocarburi alifatici e olii minerali	Chetoni
	Temperatures	Acides organiques	Alcalis dilués	Huiles végétales Gras animal	Hydrocarburs aliphatics - Huiles minérales	Ketons
	Températures	Organic acids	Diluted alkali	Vegetables oils Animal fat	Aliphatic hydrocarbon mineral oil	Ketones
NBR (6) + Viton (6)						
Nylon (7) o Teflon (7)	- 4 + 230° F	Buono Bonne Good	Discreto Discrète Fairly good	Buono Bonne Good	Buono Bonne Good	Insuf. Insuffisante Poor
Etil-Prop EPDM Grigio Etil-Prop EPDM Gris Etil-Prop EPDM Grey	- 40 + 265° F	Buono Bonne Good	Buono Bonne Good	Insuf. Insuffisante Poor	Insuf. Insuffisante Poor	Buono Bonne Good
Viton V Verde Viton V Vert Viton V Green	- 0 + 500° F	Buono Bonne Good	Discreto Discrète Fairly good	Buono Bonne Good	Eccellente Excellente Excellent	Insuf. Insuffisante Poor
Teflon PTFE Bianco Teflon PTFE Blanc Teflon PTFE White	- 40 + 450° F	Buono Bonne Good	Eccellente Excellente Excellent	Eccellente Excellente Excellent	Eccellente Excellente Excellent	Buono Bonne Good

**KIT DI GUARNIZIONI
PER RUBINETTO**

JEUX DE JOINT
POUR ROBINET

SEAL RING
FOR PLUG COCKS

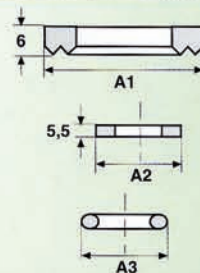

DIN - SMS - CLAMP - RJT/BS - IDF/ISS
 POSIZIONE DELLA MANIGLIA DEL RUBINETTO
 IN APERTURA PER TUTTE LE "SERIE"

DIN - SMS - CLAMP - RJT/BS - IDF/ISS
 POSITIONNEMENT D'OUVERTURE DU MANCHON
 POUR TOUTES LES SÉRIES

DIN - SMS - CLAMP - RJT/BS - IDF/ISS
 OPENING POSITIONING OF PLUG COCK HANDLE
 FOR ALL SERIES

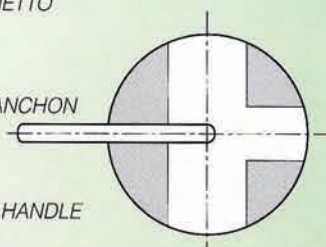

**RUBINETTO 2 VIE
ESTREMITA' LISCE**

ROBINET À BOISSEAU
2 VOIES BOUTS LISSES

PLAIN END TWO
WAY PLUG COCK

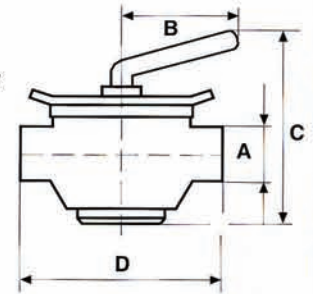

**RUBINETTO 2 VIE
ESTREMITA' FEMMINA**

ROBINET À BOISSEAU
2 VOIES BOUTS FILETÉS

FEMALE END TWO WAY
PLUG COCK

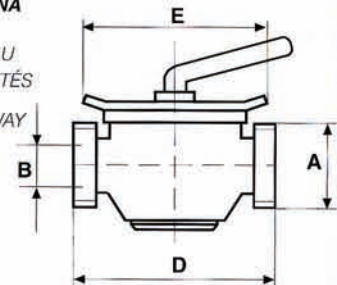

**RUBINETTO 3VIE
ESTREMITA' LISCE**

ROBINET À BOISSEAU
3 VOIES BOUTS LISSES

PLAIN END THREE WAY
PLUG COCK

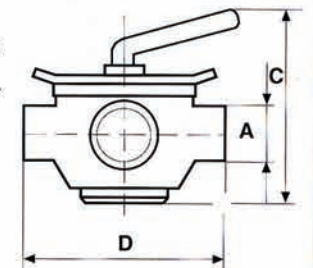

**RUBINETTO 3 VIE
ESTREMITA' FEMMINA**

ROBINET À BOISSEAU
3 VOIES BOUTS FILETÉS

FEMALE END THREE WAY
PLUG COCK

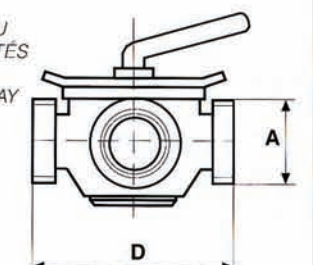

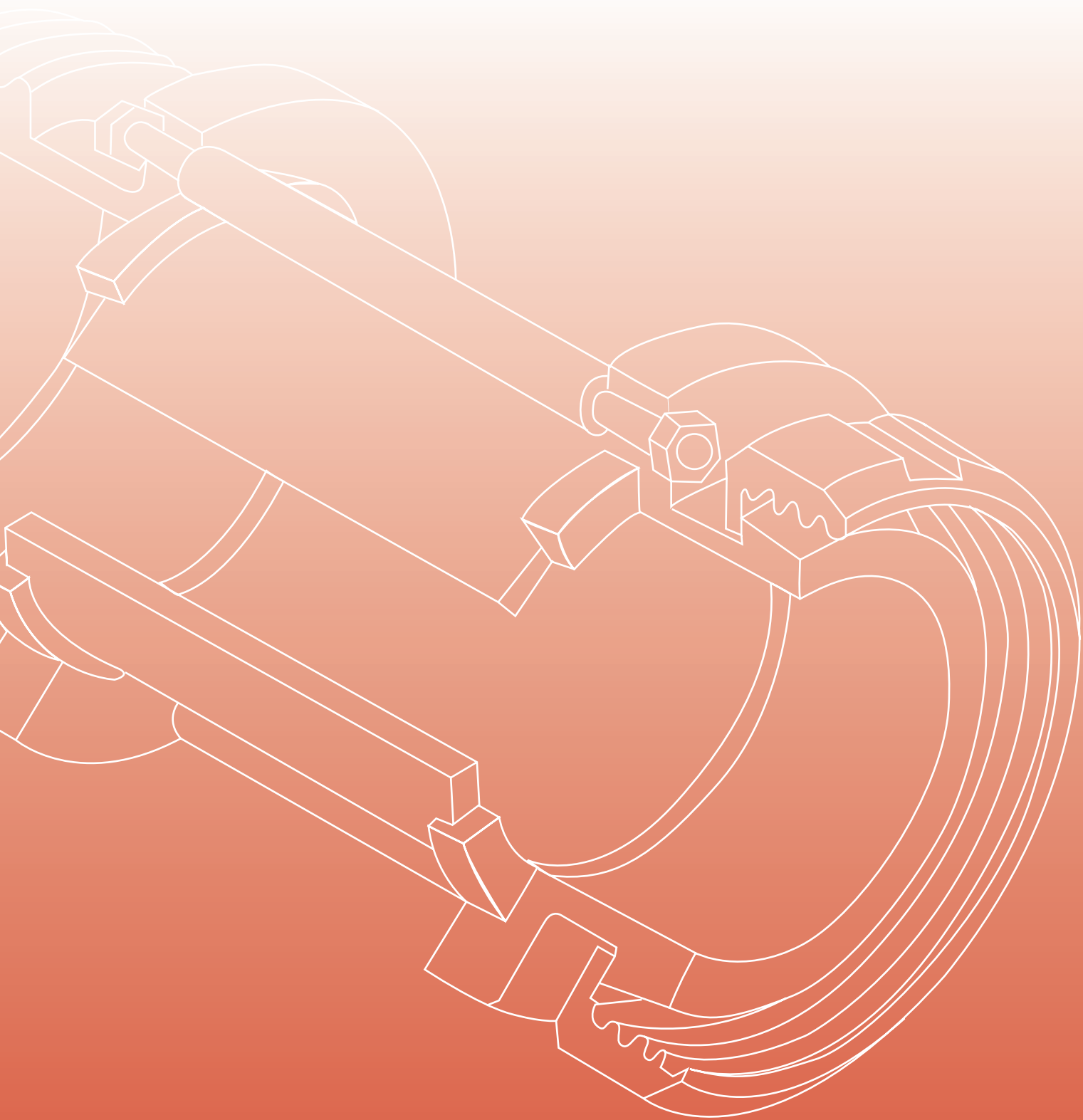

VICENTINOX s.r.l.
Via A.Volta, 50 - 36016 Zanè (VI) ITALY
Tel. 0445.315150 - Fax 0445.315144
<http://www.vicentinox.it>
e-mail: info@vicentinox.it